

May 2021
Issue 2



Welcome to our latest newsletter, which is also being produced on paper, unlike recent editions, as it is now safe to deliver it in person. If you are reading the paper version, note that the hyperlinks will work if you access the digital version from the 'Download' section of our website.

A quick thankyou

We would like to say a quick thankyou for the support of local Councillors who amongst other things have helped with the Shortlands Village Conservation Area, some problems in Farnaby Road and the planning application for Billingford in Elstree Hill. We have also appreciated the help of Cllr Alexa Michael, Chair of Bromley's Development Control Committee, who has helped with some planning situations where developers have not built in accordance with permitted plans. In particular Cllr Michael supported residents to insist that the developer of Matilda House in Hillbrow Road plant the trees they promised to screen the intrusive new block of flats.

Bromley Town Centre

In January 2021, an application was submitted relating to the pedestrianised area of Bromley High Street: details [here](#)

The application summary is for: "Installation of open air performance area and seating with canopy and sculptural interactive artworks; Bench with drinking water fountain; and 'Time Machine'".

A concept of some elements of the plan is pictured below:

A "greenhouse" in front of the locally listed Aberdeen Buildings



A bench with drinking water fountain in Market Square



A 'Time Machine' sculpture at the south end of the pedestrian area



Bromley Civic Society (BCS) was invited as a stakeholder to work with the urban designers on this project and although they fully endorsed the principle of an initiative of this kind in the Town Centre, they had serious concerns about how it had developed. Due to BCS's report and other objections, the application has been withdrawn but it is anticipated that a modified proposal will follow.

Ravensbourne Station

We are expecting a large mural to be painted on the bare wall at the station any time soon, together with large planters by the ramp on Platform 2.



The oak trees and bluebells reflect prominent characteristics of Beckenham Place Park.

Parking in Ravensbourne Avenue, unmade section

What's happening regarding parking on the unmade stretch of Ravensbourne Avenue? We understand that, at the moment, discussions are continuing between the charity landowner (Phoenix Community Housing) and LB Bromley as to what is permissible in terms of controlling parking.



Parking in the unmade section only really started when LB Bromley started charging for parking in Crab Hill and then increased further when Beckenham Place Park reopened. We have been advised that this is causing considerable difficulties for residents. For example, all the extra use has been wearing the road out (literally!), causing costs to the owner and residents running into tens of thousands of pounds. Inconsiderate parking has also been blocking residents' driveways and has obstructed emergency vehicle access.

More positively, we have been advised that the landowner and the residents wish to develop a vision of a green corridor to the park, safe for walking and cycling, with a minimum of environmentally damaging vehicle movements.

It is these issues which have prompted the possibility of changes to the parking arrangements.

In the meantime, while we wait for a resolution, please use "green" methods of transport whenever possible. Where this is not possible, please park thoughtfully - there are often spaces in Crab Hill which are either always free or free of charge at certain times.

Air Pollution

Air pollution is again in the news with a Coroner ruling that it materially contributed to the death of a 9 year old child in South London. In addition the matter was discussed in parliament [recently](#) . Smoke contains tiny particles (PM2.5) which enter the body and can do serious harm. Please burn wood (and other things) thoughtfully.

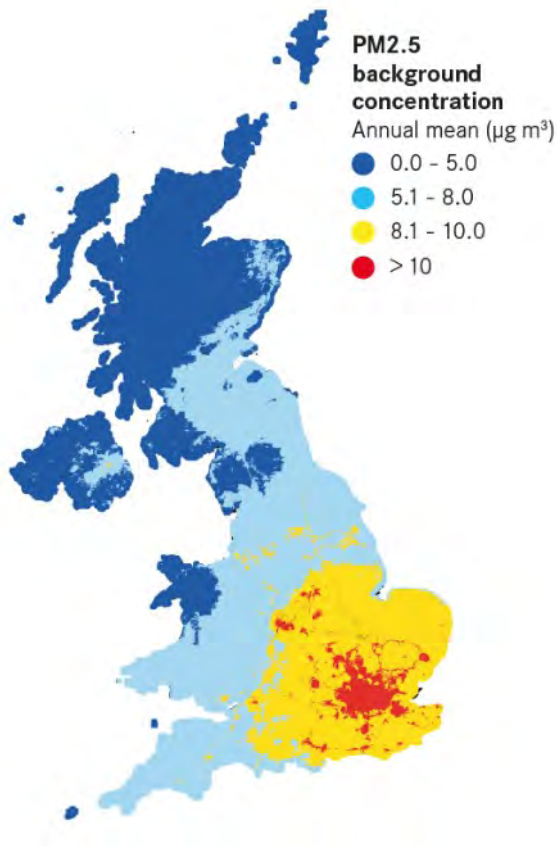

Below: pollution in the London air - we breathe that !



Environment

Please water any new trees outside your house. Just find the small slot in the top of the watering bag (not the big open collar) and fill the bag up. Also consider beautifying your tree pit.

Below are examples of tree pit beautification in Madeira Avenue by RVR residents.



Beckenham Place Park

Events and activities in the park and at the Mansion House are gradually resuming.

Here is an overview of what is planned:

Mansion House

- The basement café is re-opening from 17th May;
- Sewing classes re-start on 19th May;
- The street food market will re-start on 27th May, every Thursday and some Fridays;
- Other classes will also restart soon, including:
 - Pre-natal and Post-natal Yoga;
 - Yoga and Pilates;
 - Arts and Crafts;

Details of these and other activities can be found [here](#).

Park

- Toilets in the Homestead courtyard are open daily 9.30am-8pm;
- The [Homestead Café](#) and bar will fully re-open on 17th May;
- The car park now operates a pay and display system and there are other restrictions around parking inside the park. But please walk or cycle!;
- The lake is open for swimming and paddle boarding. Sessions must be pre-booked. See [here](#) for booking information;
- A series of photography competitions is taking place with three categories still open for entries, viz: Spring, Summer and Autumn;
- The annual flower and dog show was scheduled for Sunday 1st August but it appears it may have moved online. Unfortunately the information link on Lewisham website is broken.

Details of these and other events and activities can be found at the Mansion House link above, or at one of the following: [here](#) or [here](#).

An additional event, the pictured Film & Food Fest, is not listed on the normal webpages but instead on Facebook [here](#).



Roads and Traffic

Traffic Management

The traffic management on Albemarle Road and Westgate Road is changing again. In summary, the changes will revert Albemarle Road to two directional traffic between Westgate Road and Beckenham High Street and continue to have one directional traffic, south bound over Westgate Road bridge. These changes will be made under the existing experimental traffic order.

A clearer map and further details are on our website [here](#)

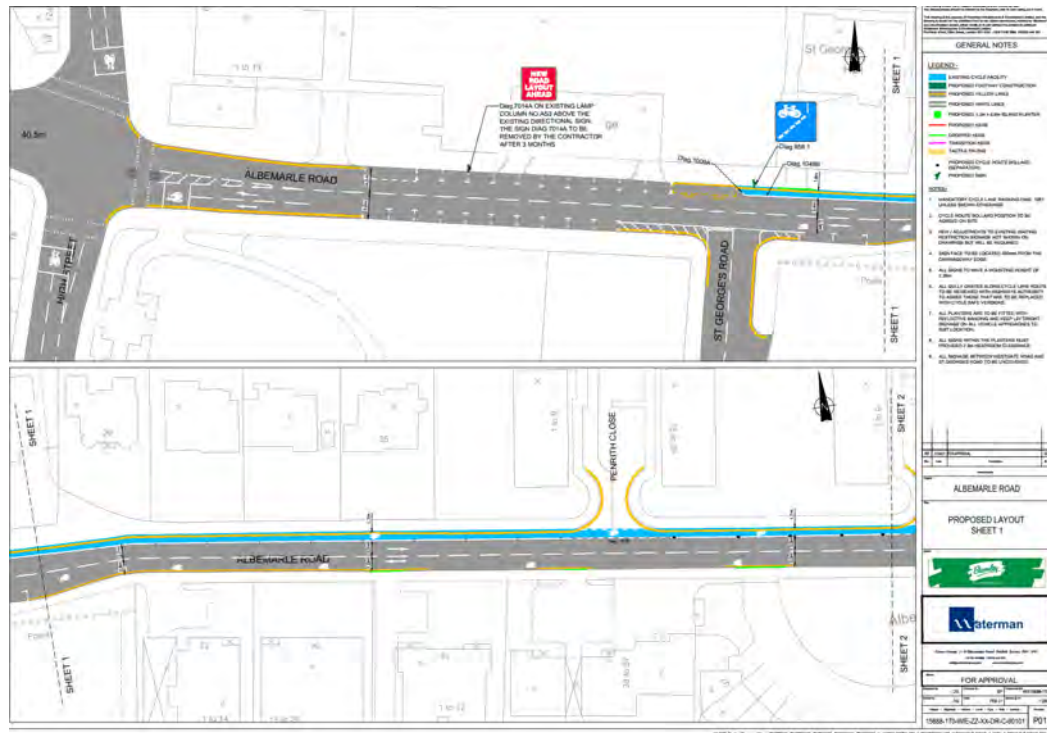

E-Scooters

Just don't ! Or at least be aware of the downsides! Fines for use on the pavement or road include:

- a Fixed Penalty Notice for no insurance, with a £300 fine and six penalty points;
- a Fixed Penalty Notice for no driving licence, up to £100 fine and three-six penalty points;
- and the e-scooter could be seized. In reality, the bigger penalty might be substantially increased car insurance premiums. More Police advice [here](#).



Society Business

Global Action Plan announces award short list

Global Action Plan is a charity promoting clean air and sustainable life styles and runs 'Sustainable City Awards'. (See [here](#)). We are delighted to announce that local resident and member Parisa Danvers has been short-listed for the 'Individual Changemaker of the Year, 2020 - community or voluntary sector' award (prize £2,500!). This reflects Parisa's work in improving the air quality at Valley School (to which we made a donation!) and for setting up [Greener and Cleaner Bromley and Beyond](#). The winner is announced on 17th May, and win or not, Parisa continues to make major difference to the lives of people in Bromley.

New Secretary Needed

We are delighted that Gillian Lees volunteered to temporarily fill the role of Secretary but we really need a volunteer for the longer term. Do please consider joining our 'executive team' – it would be greatly appreciated. (And the role is really quite straightforward!).



We are also looking for additional support to help deal with planning applications. No prior experience is necessary for what can be a varied and interesting role, protecting the area from both unacceptable and unauthorised development. About 1-2 hours per month, or more if really keen! Please contact the Chairman.



Spare Plants ?

If you have any spare plants, the Ravensmead Road community would love to receive them for their garden by the path over the river. Originally started by local children, this project has taken off and is rapidly improving what was a bare piece of neglected land. Well done!

Subscriptions

This year we intend to collect subscriptions at the door when delivering the annual roundup newsletter in July / August. Recognising that many people have stopped using cash, we can now accept subscriptions by standing order. If you wish to pay this way, please contact:

treasurer.rvr@outlook.com

Meeting Dates

Forthcoming members' meetings are as follows:-

Thursday 1st July, 2021 via ZOOM;

Thursday 2nd September, 2021;

Thursday 4th November, 2021;

We hope from September they will be at Bromley Court Hotel and not on ZOOM. Confirmation to follow.

Society Officers and Road Representatives

There have been a number of changes recently. Please note the contact details below. The most up-to-date list can always be viewed on our website [here](#).

Officers

Chairman	Clive Lees	chairman.rvr@outlook.com
Vice Chairman	Beatrice Osborn	vicechairman.rvr@outlook.com
Secretary	Gillian Lees (Acting)	secretary.rvr@outlook.com
Treasurer	Dave Wiltshire	treasurer.rvr@outlook.com
Planning Officer	<i>Vacant</i>	planning.rvr@outlook.com
Membership Secretary	Linda Müller	membership.secretary.rvr@outlook.com
Newsletter Editor	Euan McMaster	editor.rvr@outlook.com
Webmaster	David England	webmaster.rvr@outlook.com
Roads and Traffic	Brendan Donegan	roadsandtransport.rvr@outlook.com
Tree Warden	Monica Wiltshire	trees.rvr@outlook.com
LBBR Delegate	Judy Adcock	secretary.rvr@outlook.com
BPP Rep	Liz Logan	bpp.rvr@outlook.com
Hon. Legal Advisor	Richard Thomas	contact - chairman.rvr@outlook.co
Auditor	Alan Williams	contact - treasurer.rvr@outlook.com

Road Representatives

Bracken Hill Lane and Close / Highland Road
Bromley Ave / Grasmere Rd
Calmont & Ashgrove Roads / Belgravia Gardens
Coniston Road / Ullswater Close
Downs Hill / Crab Hill
Elstree Hill / Erin Close / Hillbrow Road
Farnaby Road (1-81)
Farnaby Road (82-194)
Madeira Avenue (Evens)
Madeira Avenue (Odds)
Oaklands Road / Spencer Road / Hawkshead Close /
Lullington Garth
Ravensbourne Ave. (Evens)
Ravensbourne Ave. (Odds)
Ravensmead Road
Warren Avenue

Linda Müller
Quinton Schönknecht
Rita Smith
Sandra West
Wendy Watmore
Mick Pinson
Jaki Moody
Cathy Davies
Judy Adcock
Anne Lancaster

David Page
Monica Wiltshire
Linda Harvey-Shipp
Peter Saunders
Clive Lees

If you wish to contact your representative please email the RVR Secretary or write to:

RVR
38 Warren Avenue
Bromley