

## Suggestions how to improve our area

Join us! Either on line via our website or fill in the form and send it to: Linda Muller, 4 Bracken Ridge, 26 Bracken Hill Lane, Bromley BR1 4AT

✂

Name: _____
Address: _____ _____ _____
Email: _____

Our subscription fee is £5pa or donation for OAPs. Your records are kept confidentially on computer and will never be sold.

A few suggestions of things you might do to help:

- Sweep debris from behind parked cars or telephone cabinets to where the road sweeping lorry/pavement sweeper can get it;
- Cut back shrubs that overhang the pavement and spray pavement weeds;
- Use [www.fixmystreet.com](http://www.fixmystreet.com) to report other problems

## Planning Applications

We have seen an upsurge in applications for possible new developments. We are particularly concerned about proposed developments in Hillbrow Road and Blyth Road. For an up to date list of proposals and their status see:

<http://www.rvpsbromley.org/planning-applications.php>

## Newly Appointed Officers

We are very happy to announce that the positions of Treasurer and Tree Warden have been taken on by Dave Wiltshire and Monica Wiltshire, respectively. Their details have been added to the list of officers on the website. If you do not have access to it feel free to contact our Chairman Clive Lees.

## Help Wanted

We are still looking for volunteers for the following roles:

### **Roads and Traffic Officer**

We are looking for someone to help maintain the standard of our roads – the principal task is to enthusiastically report potholes and other related problems. At the moment, this is performed by other RVPS Officers – to date an estimated 150 problems have been reported by others to Bromley Council and Lewisham Council this year alone.

See the example at:

[www.fixmystreet.com/report/463228](http://www.fixmystreet.com/report/463228)

### **Planning Officer**

This is a fantastic role for someone who would enjoy being involved in the local community and meeting and helping those residents who are blighted by planning applications. Interesting and diverse, the role can be very rewarding. On average, 1 to 2 hours per month are needed, but it depends on what planning applications are submitted.

[www.rvpsbromley.org](http://www.rvpsbromley.org)



July 2014 Roundup

Issue 4/2014

This is the annual roundup newsletter of the Ravensbourne Valley Preservation Society. We are a residents' society covering an area of 1500 households of which nearly 500 are subscribing members. Our objective is to maintain and enhance the built environment and to generally enhance the area for the benefit of residents.

If you are a member, thank you for your continued support over the last year. If you are not yet a member do please consider joining us. You can find out all about us at [www.rvpsbromley.org/](http://www.rvpsbromley.org/) - including those of you who live in Lewisham. There is a huge amount of information about our area on our site including our constitution - do please visit it.

## Key Achievements of the Year

Here are just some of the successfully concluded campaigns of the last year:

- Saving, against the odds, two oak trees in Crab Hill;
- Getting Lewisham and its contractors to fulfil their responsibilities and look after the Warren Avenue Playing Fields – users will have seen significant improvements recently and more are in the pipeline at the time of writing;
- Campaigning successfully against the redevelopment of Billingford;
- Making approximately 350 reports to the council about potholes, fly tipping etc. using the excellent [www.fixmystreet.com/](http://www.fixmystreet.com/). That's a lot of problems fixed for residents!

## Beckenham Place Park Developments

### **Park Restoration Project**

A plan to restore many heritage features of Beckenham Place Park and make it more attractive to a wide range of local and regional visitors has received £4.9m from the Heritage Lottery Fund and the Big Lottery.

Lewisham Council will consult current users of the park and the wider public as it develops more detailed plans for future use.

Details of the current proposal and links to further information are on our website, here:

<http://www.rvpsbromley.org/beckenham-place-park.php>

### **Flood Alleviation Scheme**

At the same link you can find information about the proposed park based flood reduction component of the Lewisham and Catford flood alleviation scheme. The information comprises Posters, Briefing Note and Maps. It is likely to be of particular interest to residents of Calmont and Ravensmead Roads, Riverpark Gardens and Ravensbourne Avenue.

## Fraud Prevention Advice

There are a number of links on our website to the latest advice on fraud awareness.

See, particularly:

<http://www.rvpsbromley.org/crime-prevention.php>

## Knotweed

Last year, Glendale, at the request of Clive Lees, very promptly treated a very large patch of knotweed in the following location in Beckenham Place Park:



As expected (as knotweed is very persistent) it now needs treating again and we have asked David Walton, Leisure Manager at London Borough of Lewisham, to arrange this.

This invasive species has been a problem for some time but recently mortgage companies are refusing to lend where properties, or even their neighbours, have this plant in the garden. In other words, if you or your neighbour has it, you may not be able to sell your property. And further, the 'owner' of the knotweed might be legally liable to their neighbours if they are affected in any way. Expert advice is needed to deal with it. It can be recognised by:

- lush green in colour;
- shovel shaped leaves;
- stem is bamboo like in appearance;
- produces white flowers around September or October;
- can grow by 10 cm a day

Lots more information and images at:

[http://en.wikipedia.org/wiki/Fallopia\\_japonica](http://en.wikipedia.org/wiki/Fallopia_japonica)

## Glassmill Pond Clean-up

A Meeting was held at Bromley Town Church on 24th June by Thames21 who are managing the clean-up project. They presented a version of the proposed plan which involves creating a flow channel along one side, to reduce the silting problem, and allowing the pond to fill up when water flow is sufficient.

The diagram below is a rough draft of what they propose:

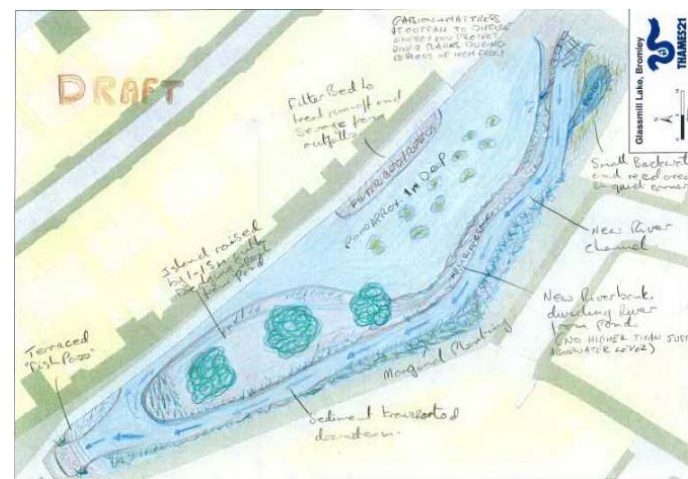

Thames21 continue to seek funding to implement the proposal. You can monitor their progress and comment on it at their website:

<http://www.thames21.org.uk/?s=glassmill+pond>

We have asked Thames21 to update the website or provide us with updates to post on our own website.

You can also sign up as a volunteer to help with this and other similar projects at:

[http://www.bromley.gov.uk/info/200073/parks\\_and\\_open\\_spaces/439/conservation\\_volunteering](http://www.bromley.gov.uk/info/200073/parks_and_open_spaces/439/conservation_volunteering)