

This public exhibition showcases proposed public realm improvements to Bromley High Street. These designs are currently in planning and will be delivered during Summer 2021.

Why?

Bromley Council is committed to improving its town centres for residents, businesses and visitors. Investing in the borough's high streets, will assist with the COVID-19 pandemic recovery and enable our high streets to thrive into the future.

In August 2020, Bromley Council appointed Turner Works and YOU&ME Architecture to design a series of improvements within Bromley High Street. The project will build on the recent landscape improvements and activate the centre beyond retail use. A place for recreation, leisure, shopping and culture.

What are we doing?

The project will deliver:

- **A Canopy structure** to provide shelter for everyday activities as well as events and festivals.
- **An outdoor performance space** to support existing and extended cultural programming on the High Street.
- **A covered seating area** inviting visitors to dwell and use the public realm in any weather and thereby support local shops and food outlets.
- **Two artworks** to celebrate Bromley's identity and contribute towards its sense of place and unique character.

Design Concept: The Famous Five

Turner Works and YOU&ME Architecture have responded to the project brief with five interventions. These 'Famous Five' pieces draw inspiration from different elements of Bromley's past and present. Collectively they tell Bromley's story.

Themes include 'Music & Culture', 'Science & Technology', 'Fiction & invention', 'Hospitality, Health and Nourishment'. These stories and references will be as woven into the designs through text, poems, maps and playful light projections.

These themes have been developed through consultation with key stakeholders and poetry co-creation sessions between local community groups and Poetry Machine's Beth Calverley.

About the design team:

The design team is led by Turner Works, an award-winning architectural and urban design studio responsible for some of London's most high impact projects. TW design projects include Pop Brixton, Peckham Square masterplan and Peckham Levels.
www.turner.works

YOU&ME Architecture is a multi-disciplinary artist and architecture studio who have delivered several public realm high street regeneration, place-making and public art projects. YOU&ME have recently worked in Bromley, delivering the Penge shop front improvement scheme.
www.youandmearchitecture.com

Where to find out more:

Project blog	bromleyhighst.tumblr.com
Instagram & Twitter	@bromleyhighst
Planning Application	The scheme is currently in planning. Once validated it will be available to view online: searchapplications.bromley.gov.uk Ref: 21/00337/FULL1



- A. The Green House** – large canopy structure that houses performance space and seating
- B.** External area for additional flexible seating
- C.** Zone for demountable projection screen to be viewed from either side
- D.** Stage on raised platform
- E.** Flexible area to increase either performance space or flexible seating under canopy
- F. The Punk Rock** – tiered formal seating with timber seats, large central planter with mature planting and informal tiered seating facing south
- G. The Story Seat** – meandering bench with surface of hand painted tiles that tell the stories of Bromley.

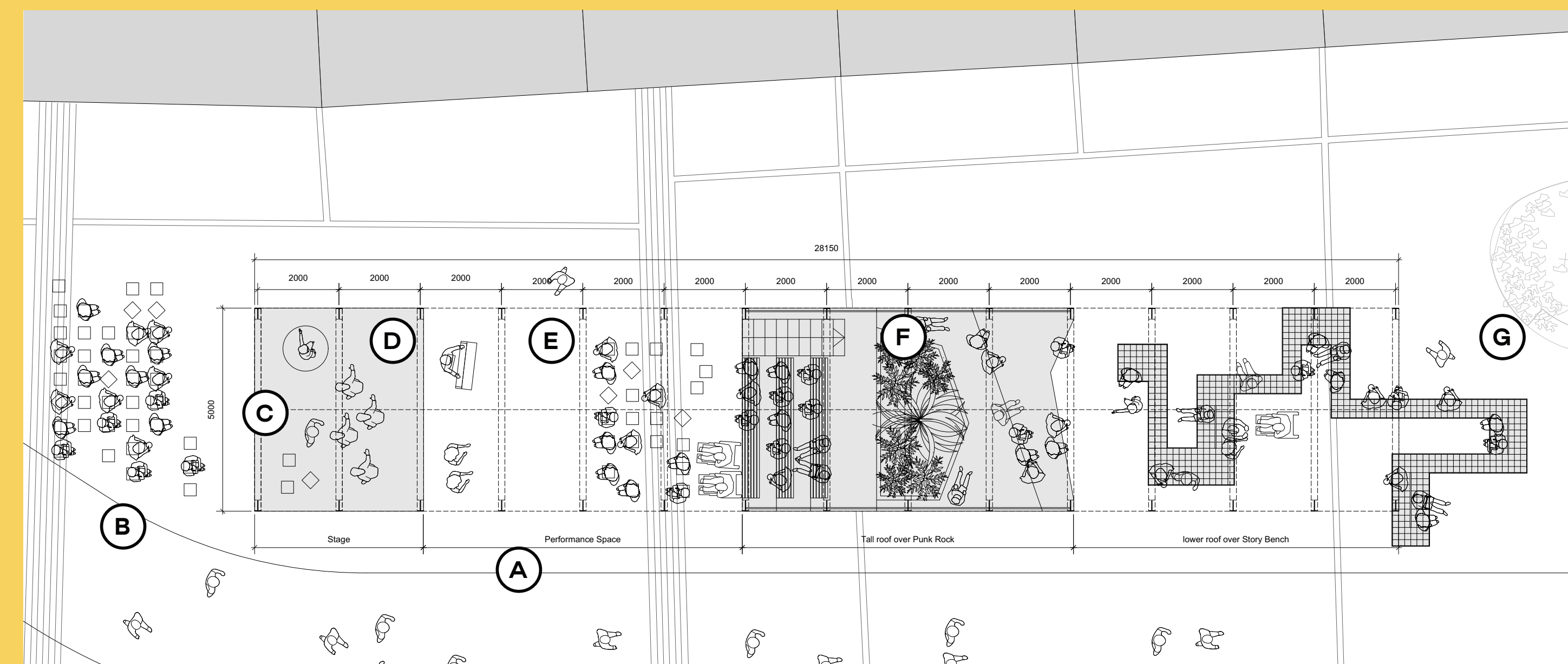

1. The Green House:

The main structure on the central site will be the Green House, a timber glazed canopy which references Charles Darwin, Crystal Palace and Bromley's half-timbered houses. The Green House will be a lightweight, welcoming and light filled space which will glow at night with low energy lighting.

Located centrally and close to Churchill Theatre and Bromley Library, the canopy, seating and performance area will form a new hub for everyday use as well as larger events on the High Street. The location benefits from close proximity to central public facilities as well as links to Church House Gardens. The new interventions will correspond with the flexible use of Churchill Square.

2. The Punk Rock:

The Punk Rock takes inspiration from the music heritage of Bromley. Situated underneath the tallest part of the Green House, it provides tiered seating facing the stage, and also gives as a raised platform for informal performances and sitting. The pre-cast concrete steps include inset hardwood timber seats, a large planter and storage.

3. The Story Seat:

Partly covered by the Green House canopy, the Story Seat will be a winding bench tiled with community poems, stories, maps and illustrations. The bench will incorporate phone charging points and a WiFi hotspot.



Bromley High Street Regeneration: A new outdoor performance space, covered seating and artworks

4

Artwork: The Time Machine

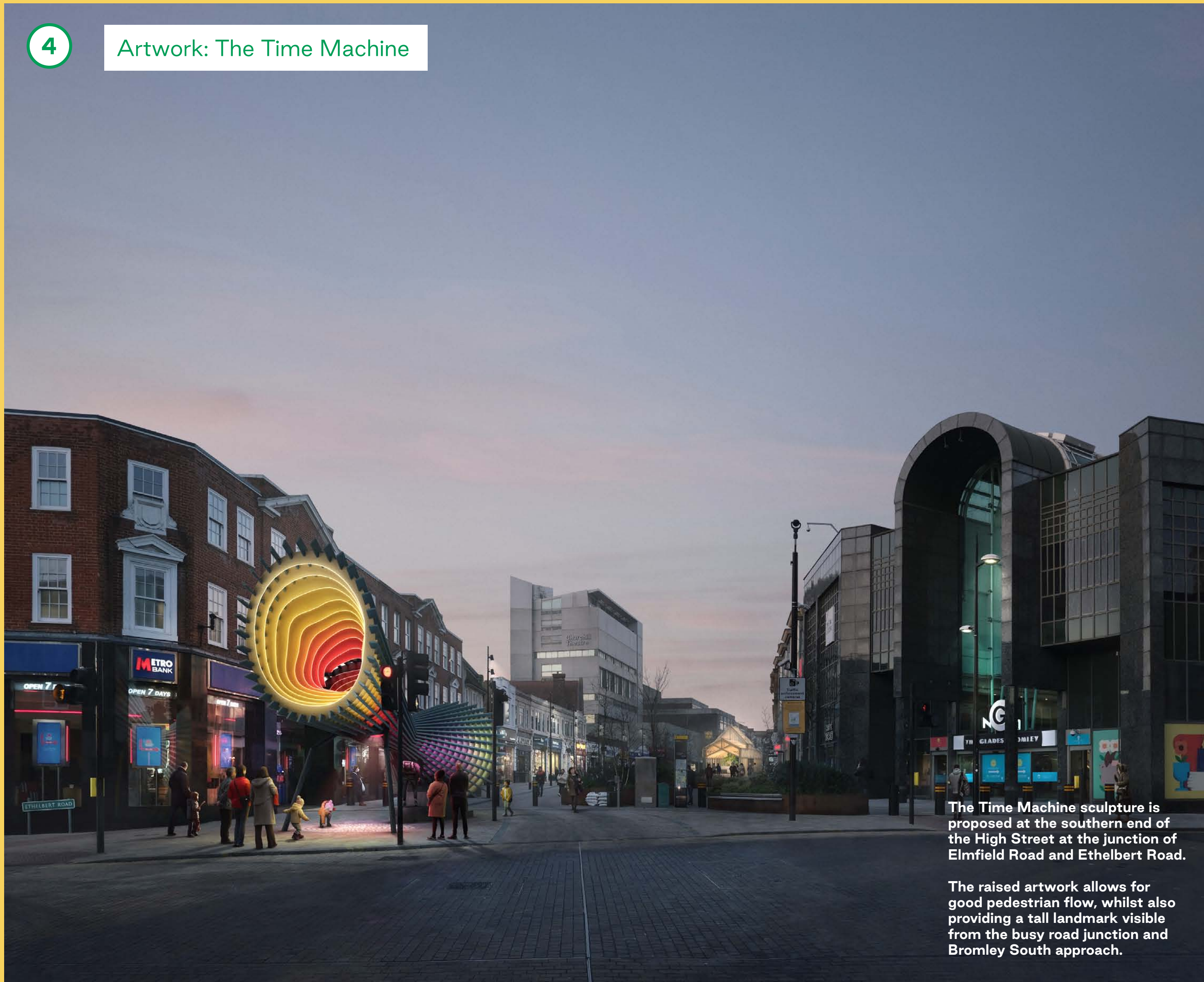

The Time Machine sculpture is proposed at the southern end of the High Street at the junction of Elmfield Road and Ethelbert Road.

The raised artwork allows for good pedestrian flow, whilst also providing a tall landmark visible from the busy road junction and Bromley South approach.

5

Artwork: The Broom Flower



The Broom Flower sculpture is proposed at the northern end of the High Street, at the junction of Market Square and the High Street.

4. The Time Machine:

The Time Machine is an experiential sculptural installation that celebrates Bromley's literary heritage, with specific reference to H.G. Wells' science fiction writing. The design plays on abstracted time travel theories of time machines, time tunnels, worm holes and portals. It plays with false perspective, cosmic circular forms and illusion.

The artwork incorporates a new poem for Bromley, derived from poetry co-creation sessions with local community groups and poet Beth Calverley. This new piece of writing will reflect Bromley's past and present dynamic.

The installation is experienced at different scales. It works both as an illuminated beacon from afar, as well as being immersive at an individual scale: You can sit within the worm hole; look up through its underbelly and mirror periscope; or be flooded by the poem light projection. The installation uses bright colours, low energy lighting and floor projections to create a dynamic piece which has different qualities in the day and night.

The double cone framework is made from powder coated slatted metal, with concrete steps and timber seating.

5. The Broom Flower:

The Broom Flower is a sculptural jewel-like funnel which incorporates a drinking fountain, curved bench and planter. The form and golden colour takes cues from the Broom Flower after which the town is called – "The place where Broom grows".

This artwork represents 'Health & Nourishment' and celebrates the significance of water within Bromley. It references the town as a coaching route stop and creates a stopping point along the busy high street. A place to rest, meet a friend, wash your hands or fill up your water bottle.

The playful rain collection funnel waters the planter and also appears to supply the drinking water point, to create an educational and sustainable design and talking point. Plaques incorporated within the seating will tell the story of the healing properties of St. Blaizes' well, the Town Pump and the significance of the Bromley Broom flower.

Engagement:

These designs have been developed with key stakeholders including: elected town ward councillors (Councillor Dykes, Harmer, Morgan & Rutherford); Your Bromley BID; LBB Town Centre & market team; Bromley Civic Society; Bromley Library and Churchill Theatre.

Poetry co-creation sessions:

As part of our design process, we have worked with local groups to share their thoughts, feelings and memories of Bromley, as well as hopes for its future. Beth Calverley from The Poetry Machine has guided participants through these sessions remotely. Each group was given a choice about how to take part – some wrote the poems themselves, while others had a conversation with Beth, who wove their words into poetry, live in the moment, on her vintage typewriter.

Collectively, these will inspire a new poem for Bromley, which will be incorporated within the Time Machine Artwork. Further poem extracts and community stories will be displayed within the Story Seat and fellow interventions, embedding these voices into the High Street landscape.

TRADING IN TRUST

for Bromley Charter Market

Every morning, you can feel the buzz of trust. Whatever the weather, everyone working well together. Customers come here on the bus not just for the fish or hats or fabrics, but for conversations too. You can hear the passion in the air. Cold hands, warm hearts. Life stories shared. Each trader is a member of a family, grown up among the bustle. Leave your stall for as long as you need and know that someone will keep it safe.

Markets survive among the change. People come to meet each other and to help us know we fit. Exchanging smiles more valuable than coins.

Home is a currency that sticks.

FEEDBACK

for Geoff & Patsi

There's feedback in the air tonight. A melting pot of music waits within the back-pub open mic. We're still here, still going – the flow of energy between the generations. Punk belongs in Bromley – always has – from Billy Idol to Billy Bragg; from Siouxsie Sioux to Poly Styrene.

This is where our sound is meant to be. But when you close a pub, you close communities.

Punk is more than just a scene; it's behind-the-scenes as well – friendships networked round the mic. A talentscape of happy lives.

So listen to the feedback in the air tonight.

The future is a place for part of Bromley's heritage to turn its volume up and let us play.

THIS IMAGINATIVE ATMOSPHERE

written by members of Bromley Youth Council

Bromley Park,

where colourful flowers show among the green grass and joyful children run across the playground. Not much has changed this imaginative atmosphere.

High Elm – I love how big it is,

with the flower gardens by the huge field. I remember when we used to go there with my family to play hide and seek in the woods.

Beckenham Park,

where historical trees form a tunnel to a lake of opened sky. People greet you, smile at you, feeling the connection of smell – the fresh rain mud.

There was a time when loneliness filled the air and no-one was there – a deserted atmosphere.

Before I arrived in Bromley, I felt I needed to return home. I remember when I sensed I was part of this place – when I said for the first time: don't worry, we're home.

I wish there would be no investment borders in Bromley. One day, everyone will have an acronym for getting help and Bromley young people will be recognised as a referent of commitment –

happy and kind-hearted. Proud to be Bromley spirit's creators.

THE BEAUTY OF BROMLEY

written by members of the Teenage Book Club

The pie and mash shop in Orpington. The Whitehall Park in Rickley. The markets with their different-coloured fruits. The market-holders' voices, shouting, carry far, each one unique.

Records playing – dancing in the doorway of the library. The hustle-and-bustle and baskers on the Bromley High Street.

Take some fruit in your hands to taste. The feel of books, smooth in their jackets, sturdy or rough to the touch, enticing. The waft of coffee.

The smell of people's homes between the pages. Or new books – so exciting. Juicy sweetness – fresh, authentic.

I remember playing in the park in Chislehurst with my Nan.

I remember going to the park with my friends to play football.

There was a time when Spitfires danced over Bromley, engaged in war, vapour trails behind, scars in the sky.

There was a time when I would go to the shops with my Mum and brother and come back with more things than we knew we needed. A part of my childhood. One day, we'll travel in electric cars – there will be no noise, no pollution, no traffic.

We'll hear the birds singing. We'll walk in the woods after this time apart – being together again.

I hope for a time when knife crime and other bad things won't happen. We will think of the future generations.

IN OUR HAPPY PLACE

written by members of Jub8

People having fun at the swimming pool. Families in Church House Gardens having picnics. Little children playing with their friends on the swings. Kids screaming, dogs barking, people talking. Party songs in my Grandad's club. Water rushing. Summer's hand like your husband. Cold drinks. The feel of the grass – wet and muddy or tickly and scratchy. Running away from the rain. The taste of leaves on the floor, chewy. The smell of pollen. Being outside and mixing with our families.

There was a time before I started Jub8, when I felt nervous, but then I met up with people and it was so calm.

There was a time when Doughton was just fields. During the war, our primary schools were hospitals. There used to be a pub next to my house called the Beech Tree.

I remember the feeling of sand between my toes at the sandpark, after the cinema. One day, there will be more activities for everyone to do – like paintballing and a transpoline park. I hope I can be in Jub8 for years and years and go on lots of trips. I wish for happiness within us all, brightening up everyone's smile.

We will always be a community. We will always be a family.

PROUD OF THE SUNRISE

written by members of Bromley Youth Council

This is the forest by my house –

the rays of sunlight break through the thick canopy of the trees, as I hold his hand in mine, feeling bubbles of happiness and calm build up inside me.

This is Shaftesbury Park, near to where I live. This park is a place of growth, a park that I resonate with. I lend my gaze to the emerald landscape, a horizon closed by the trees. I feel the essence of freedom: escape. I sense what it means to be me. Light radiates among glistening leaves, shining a ray of hope. This park conveys every emotion within me; the needs of nostalgia.

This is the Civic Centre – walking down long corridors, can't wait to get in. My colleagues, my friends, are waiting to begin. The traffic lights were always red, but now I relax and the harmony begins.

I remember when I first started youth council; I was slightly smaller and slightly less confident than I am today.

A time that eludes me – the past.

There was a time when I was carefree, unshackled from the responsibilities of being a member of society. There were more days when I had a genuine smile than the days where the tears would be the ones unshackled. As a student, I blended in with the background. Ordinary. Run-of-the-mill. And then I joined the Bromley Youth Council.

One day, my local area will be just as much a safe haven for everyone as it is for me. We will make the world a better place for our generation.

I wish there were playgrounds as tall as the sky, made especially for us big kids with bigger slides, and zip lines reaching up; the tunnels longer to look for treasure.

SHARING THE LIGHT

for Bromley & Sheppard's Colleges

The women who came here when this place was founded were vulnerable, seeking comfort. Still, its woodland is a breathing space, a haven. The timeless balm of urban nature. You can feel the history in traces – old graffiti, metal rings, the air raid shelter. And the future here is just as strong. The bustle of the nearby market and its traders' cheerful cheekiness (once they get to know you). The future holds the freedom pass for bringing people close – sharing the landscape of our home, a community built around the fire of welcome. The merriment of warm accord. The sing-song of a neighbourhood as one. A bench where everyone can rest. A place where everyone belongs.

KEEP THE LIFELOOD PUMPING

for Bromley Theatre Guild

In village halls and theatres across our borough, we learn our lines – not for ourselves, but for each other. Locals stepping into borrowed shoes for generations. Helping the lifeblood of communities to flow. From Bromley Little Theatre's 1930s charm, to Churchill Theatre's 70s come-back show, to Farnborough Village Hall, where shared emotions sit in cosy rows.

Step out of yourself and into yourself at once. Weekend sets and handmade props. A place where everyone belongs.

We'll refurbish the rickety bones and bring its sound and vision up to date – yet keep its heart the same; our legacy goes hand-in-hand with change. More voices, more ideas, same lifeblood in our borough's veins.

LOOKING UP

for Bromley Civic Society

From far and wide, historic visitors were drawn to Bromley for the healing waters, then, years later, for the dreamy walks;

the cosy magic of our parks – a town bathing in green. From here, look up: so much to see;

so many buildings' smiling charm – from Bromley College to the Palace, the Star & Garter to the Railway Tavern.

It's not about clinging to a past that's gone. It sets the tone for celebrating what we've got. So much love must not

be lost. It's about hard work – applying for a building to be Grade 2 listed, and protests on College Green in the 80s.

It's about the wonder carved on people's faces, when they look up at the details of our heritage, built by local traders'

lifelong sweat and smiles – and say: "I didn't know we had this here. Has this been waiting for me

all this time?"

Bromley High Street Regeneration: A new outdoor performance space, covered seating and artworks