

NOTES

1. SURVEY CONTROL:
  - a) SURVEY GRID (HORIZONTAL): THIS SURVEY IS ORIENTATED TO ORDNANCE SURVEY GRID NORTH. THE SURVEY IS TO A PLANE GRID. HORIZONTAL MEASUREMENTS TAKEN FROM THIS SURVEY WILL BE GROUND DISTANCE.
  - b) LOCAL SCALE FACTOR (LSF) APPLICABLE TO THIS SITE IS 0.99984. CALCULATED USING STANDARD TABULATED DATA.
  - c) THE CONTROL HAS BEEN ESTABLISHED BY TYING INTO THE ACTIVE ORDNANCE SURVEY CONTROL NETWORK. SEE NOTE C. BELOW.
  - d) FOR THIS RELATIVELY LOW LEVEL SITE, MEAN SEA LEVEL CORRECTIONS (MSL) ARE DEEMED TO BE INSIGNIFICANT AND HAVE THEREFORE NOT BEEN APPLIED.
2. VERTICAL DATUM: ALTITUDES FOR THE CONTROL HAVE BEEN CALCULATED FROM OPS DERIVED HEIGHTS AND CONVERTED TO ORTHOMETRIC HEIGHTS (ORDNANCE DATUM NEWLYN-ON) USING OS02G2 TRANSFORMATION PARAMETERS.
3. OPS CONTROL: THE CO-ORDINATE SYSTEM USED FOR THE PRIMARY CONTROL IS OS0286. THIS HAS BEEN CALCULATED FROM ETRIS USING OS0286 TRANSFORMATION PARAMETERS. OBSERVATIONS HAVE BEEN TAKEN ON THE FOLLOWING DATE (S): - 01/10/2014
4. THIS DRAWING IS TO BE READ IN CONJUNCTION WITH ALL OTHER RELEVANT DRAWINGS/DOCUMENTATION.
5. CHECK SCALE BAR AND GRID BEFORE TAKING MEASUREMENTS FROM THIS DRAWING.
6. IF IN DOUBT ASK.

LEGEND

- 30.29 SPOT LEVEL
- STN SURVEY STATION
- SARLING SARLING
- BUSINESS SHRUB BUSINESS SHRUB
- MEDEGAREA OF UNDERGROWTH MEDEGAREA OF UNDERGROWTH
- TREE (INDICATIVE ONLY) TREE (INDICATIVE ONLY)
- BUILDING BUILDING
- RETAINING WALL RETAINING WALL
- BANKING BANKING
- GATE GATE
- OVERHEAD CABLE OVERHEAD CABLE
- FENCE WITH DESCRIPTION FENCE WITH DESCRIPTION
- CB CLOSE BOARDED
- IR IRON RAILING
- PAW POST AND WIRE
- PAR POST AND RAIL
- COL COLUMN
- CONC CONCRETE
- DP DOWN PIPE
- EV EAVES LEVEL
- ER EARTH ROAD
- G GULLY
- GP GATE POST
- L<sup>P</sup> LAMP POST
- M<sup>H</sup> MANHOLE
- IP INLET
- R/RD ROOF/RIDGE LEVEL
- RAC RAINWATER PIPE
- TAL TREE SHOULDER LEVEL
- TP TELEPHONE POLE
- TW<sup>T</sup> TOP OF WALL
- WM WATER METER

ABBREVIATIONS

- COL COLUMN
- CONC CONCRETE
- DP DOWN PIPE
- EV EAVES LEVEL
- ER EARTH ROAD
- G GULLY
- GP GATE POST
- L<sup>P</sup> LAMP POST
- M<sup>H</sup> MANHOLE
- IP INLET
- R/RD ROOF/RIDGE LEVEL
- RAC RAINWATER PIPE
- TAL TREE SHOULDER LEVEL
- TP TELEPHONE POLE
- TW<sup>T</sup> TOP OF WALL
- WM WATER METER

STATION CO-ORDINATES

STATION	EASTING	NORTHING	LEVEL	DESCRIPTION
STN1	53938.25	170084.50	44.12	SURVEY NAIL
STN2	53938.22	170078.21	43.05	SURVEY NAIL
STN3	53937.27	170100.87	44.29	SURVEY NAIL
STN4	53944.20	170094.55	46.52	SURVEY NAIL
STN5	53942.03	170092.07	45.24	SURVEY NAIL
STN6	53944.58	170083.75	45.52	SURVEY NAIL
STN7	53944.20	170095.37	52.95	SURVEY NAIL
STN8	53944.54	170100.41	55.18	SURVEY NAIL

UNLESS OTHERWISE STATED THE SURVEY STATIONS LISTED ABOVE ARE ONLY INTENDED TO BE USED FOR TOPOGRAPHICAL SURVEYS AT THE STATED SCALE. DUE CONSIDERATION SHOULD BE GIVEN TO LONG TERM STABILITY OF SURVEY STATION MARKERS.

GENERAL

- NO ALLOWANCE HAS BEEN MADE FOR SUB SURFACE ENTRY INTO MANHOLES OR OTHER CHAMBERS OR VOIDS BELOW GROUND LEVEL. THEREFORE ANY DETAILS RELATING TO SUPPORTS ETC ARE TAKEN FROM ABOVE GROUND AND AS SUCH WILL BE APPROXIMATIVE ONLY.
- THE CONTRACTOR IS TO CHECK AND VERIFY ALL CRITICAL DIMENSIONS AND LEVELS BEFORE WORK STARTS.
- IF SURVEY STATIONS SHOWN ON THE DRAWING MAY BE ASSUMED ROUTES AND WILL NORMALLY BE OF UNKNOWN CONDITION, CONTRACTORS SHOULD UNDERTAKE SUITABLE VALIDATION SHOULD BE FOLLOWED.
- IF THERE IS ANY CONFLICT BETWEEN THE DETAILS INDICATED ON THIS DRAWING AND THOSE INDICATED ON OTHER DRAWINGS, THEN THE DRAWING SHOULD BE INFORMED PRIOR TO CONSTRUCTION ON SITE.
- IT IS IMPORTANT TO NOTE THAT THE SAME ACCURACIES IMPLIED BY THE PLOTTING SCALE ARE USUALLY APPLICABLE TO ORIGINAL DATA SUPPLIED FOR CAL.
- EVERY EFFORT IS MADE TO IDENTIFY ALL VISIBLE ABOVE GROUND FEATURES. HOWEVER, IT SHOULD BE BORNE IN MIND THAT THERE MAY BE ITEMS OBSERVED AT THE TIME OF SURVEY, VISIBLE FEATURES IN THE VICINITY OF THE BOUNDARIES AS SHOWN ON THE SURVEY, MAY NOT REPRESENT THE EXTENT OF LEGALLY CONVEYED OWNERSHIP.

DESCRIPTION	REV	DATE	DRWN	CHKD	APPR

DRAWING STATUS

INFORMATION

**Tower Surveys**  
Chartered Surveyors  
Geomatics Land Use, Engineering & Building

NO. 1 SOUTH HOUSE  
BOND ESTATE, BOND AVENUE  
MELTON KEYNES  
MK1 1SW  
TEL: +44 (0)1600 33640  
info@towersurveys.co.uk  
www.towersurveys.co.uk

London Borough of Bromley  
24 DEC 2014  
INSPECTION AND MEASURE SERVICES

CLIENT

ARCHITECT ZONE

PROJECT TITLE

DRAWING DETAIL

TOPOGRAPHICAL SURVEY AS OF 01/10/2014  
14 / 05 0 19

DRAWN	MJ	DATE	OCTOBER 2014
PROJECT ENGINEER	NJD	SCALE	1:200 (WHEN PLOTTED @ A1)
CHECKED	AC	DRAWING NUMBER	R-10279/201
APPROVED	AC	REVISION	

TREE SCHEDULE

No.	DIAM	SPREAD D	HEIGHT
TE01	0.15	3	2
TE02	0.20	6	5
TE03	0.10	3	1.5
TE04	MB	14	14
TE05	MB	6	6
TE06	MB	6	6
TE07	0.40	16	16
TE08	0.25	4	4
TE09	0.40	12	14
TE10	MB	4	12
TE11	MB	6	6
TE12	0.15	4	6
TE13	0.15	4	6
TE14	MB	6	6
TE15	0.20	6	6
TE16	MB	6	6
TE17	0.30	6	6
TE18	0.10	4	6
TE19	0.40	6	6
TE20	0.60	18	18
TE21	0.30	10	10
TE22	0.25	6	6
TE23	0.30	4	6
TE24	0.40	12	12

- TREE NOTES:
- a) MB 'X' NO - MULTIPLE BOLES FOLLOWED BY NUMBER OF.
  - b) DIAM - DIAMETER MEASURED AT APPROXIMATELY 1.3M ABOVE GROUND LEVEL.
  - c) SPREAD - DIAMETER OF CANOPY. (TREE SPREADS ARE INDICATIVE ONLY AND ARE REPRESENTATIVE OF THE GENERALISED CANOPY SIZE, AND MAY NOT REPRESENT THE TRUE CANOPY POSITION AS OUTLINED ON SITE - TREE BOLES MAY NOT BE CENTRALLY TO THE CANOPY).
  - d) HEIGHT - APPROXIMATE HEIGHT TO TOP OF CANOPY - ESTIMATED FROM GROUND LEVEL.
  - e) ATTENTION SHOULD BE PAID TO THE ORIGINAL TOPOGRAPHICAL BREF AS TO WHAT TREES HAVE ACTUALLY BEEN SCHEDULED, I.E. THOSE TREES LARGER THAN DIAMETER 'X' OR ONLY TREES WITHIN THE MARGATE SURVEY LIMITS. THIS IS NORMALLY THE CASE UNLESS OTHERWISE SPECIFIED AS INCLUDING 'OFF SITE' TREES.

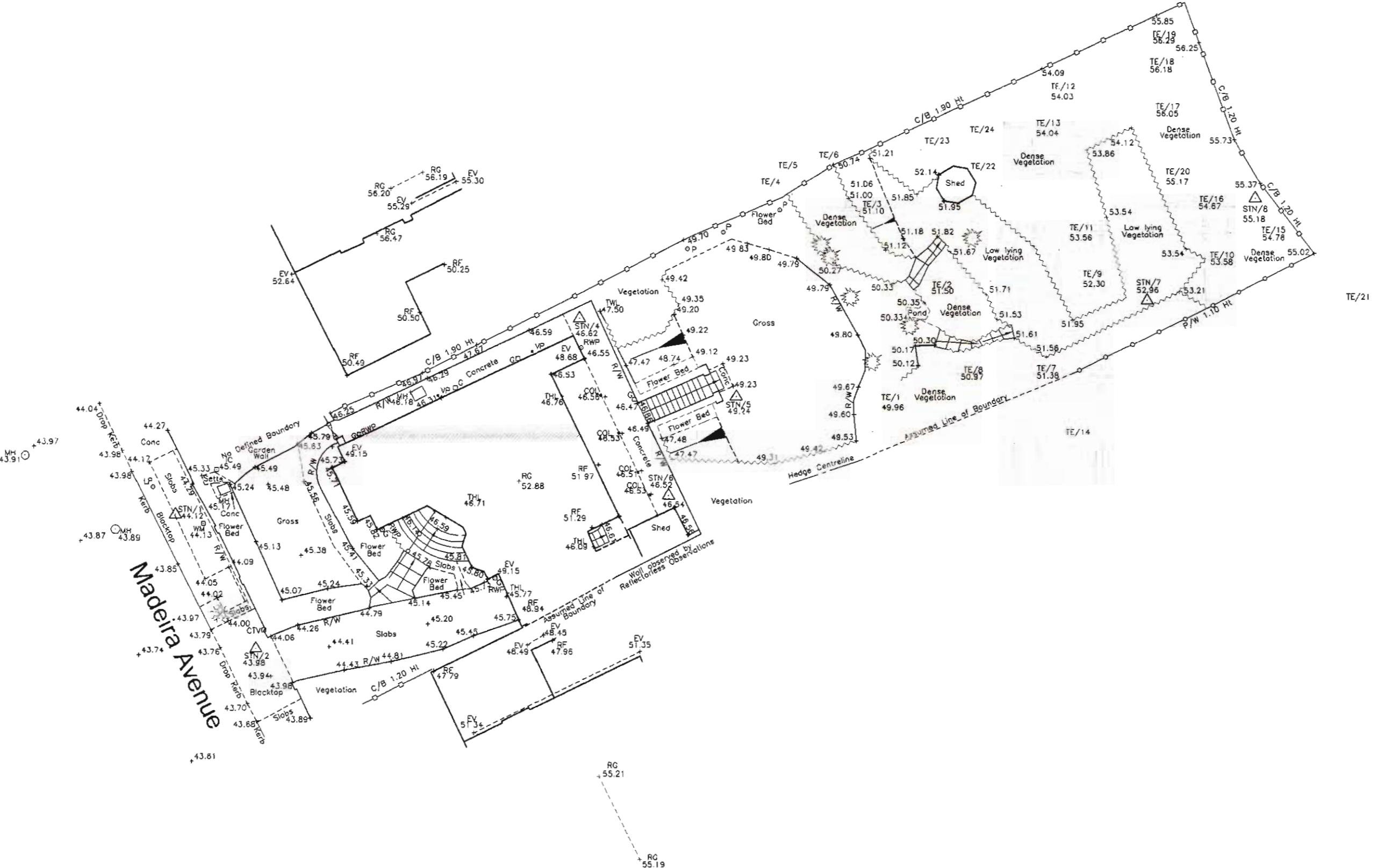
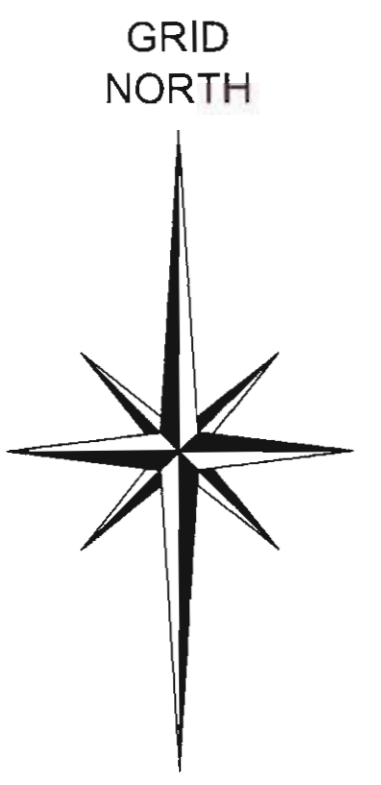

E 539360 E 539380 E 539400 E 539420 E 539440 E 539460

N 170140 N 170120 N 170100 N 170080 N 170060

Madeira Avenue

0 20 METRES

© Tower Surveys Limited. All rights reserved. This drawing is the property of Tower Surveys Limited and is not to be used for any other purpose without the written consent of Tower Surveys Limited.

MASTER COPY  
DO NOT REMOVE